

TuneMatic

Automatic Motorized Antenna Controller

FLEX-1 INTERFACE SUPPLEMENT

For FLEX 6000 series- USB option

Rev. 9/25/18

The Flex-6000 interface requires user to set rig in AM mode, 10-20W output during TUNE or STORE operation of TuneMatic.

- 1) Connect RCA phono plug to rig PTT jack.
- 2) Connect USB plug to rig USB jack.
- 3) Connect power leads to 12v source.
- 3) Connect white TuneMatic socket to TuneMatic interface port.

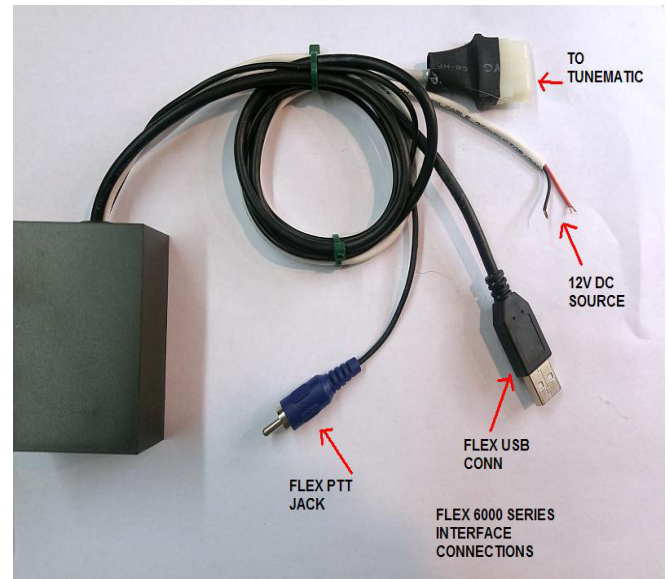

- 4) Set rig to AM mode, 10-20W output during TUNE/STORE operations of TuneMatic. Then return rig to desired mode when tuning/storing is completed.

JT Communications- Ocala, FL 34470 USA 352-236-0744 www.tunematic.us